

SportDesign Package (I-no. XAT)

CAUTION

Different approach angle compared to standard vehicle

- Risk of damage to components
- ⇒ Avoid steep ascents, descents or ramps wherever possible.
- ⇒ Always drive according to the prevailing driving conditions.

NOTICE

Cleaning the vehicle

- Risk of damage to the vehicle, paintwork and components
- ⇒ When washing the vehicle in an automatic car wash, check that the spoiler is detected by the light barriers.
- ⇒ If in doubt, seek the advice of the operator of the automatic car wash.
- ⇒ Only use cleaning agents listed in the owner's manual.



Information

Please inform the customer of this accordingly.

Concern: **Retrofitting**

Model Year: **As of 2013**

Note: The SportDesign package comprises the following components:

- New front apron
- New spoiler lip
- New rear apron (ready-primed)

If it has not already been installed in the vehicle, a –middle– radiator (I-no. 153) also needs to be retrofitted.

The components have been tested and approved together. Fitting of individual components is not permitted!

The SportDesign package (⇒ *Figure 1*) is also available straight from the factory for new vehicles by requesting optional equipment "XAT".



Figure 1

Parts Info:	981.044.800.80	⇒ SportDesign package –prime coated–, set for basic vehicle
	981.044.800.81	⇒ SportDesign package –prime coated–, set for vehicles with headlight cleaning system = headlight washer system (I-no. 288)
	981.044.800.82	⇒ SportDesign package –prime coated–, set for vehicles with front/rear ParkAssist (PA = I-no. 636)
	981.044.800.83	⇒ SportDesign package –prime coated–, set for vehicles with headlight washer system (I-no. 288) and ParkAssist (I-no. 636)
	981.044.800.78	⇒ SportDesign package –prime coated–, set for vehicles with rear ParkAssist (PA = I-no. 635)
	981.044.800.79	⇒ SportDesign package –prime coated–, set for vehicles with headlight washer system (I-no. 288) and ParkAssist (I-no. 635)

Also order the following according to **vehicle equipment** and **country version/market**:

981.701.051.18.1E0 1 x Number plate carrier, assembly kit (I-no. 211/075)

ONLY for vehicles WITHOUT –middle– radiator (I-no. 153): Order additional parts for –middle– radiator in accordance with the parts list!

Parts List:

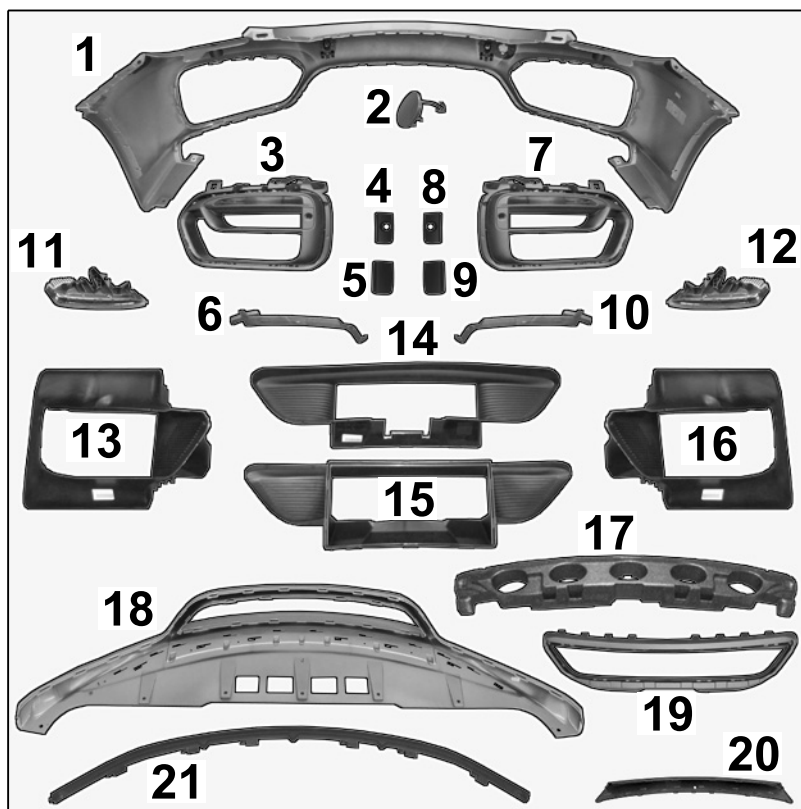

Figure 2

Scope of front apron:

981.505.011.52 ¹	1 x	Front apron –prime coated–, basic (not shown) Material: PP-T20-HI
981.505.011.50 ¹	1 x	Front apron –prime coated–, I-no. 288 (not shown) Material: PP-T20-HI
981.505.011.53 ^{1 2}	1 x	Front apron –prime coated–, I-no. 636 (not shown) Material: PP-T20-HI
981.505.011.51 ^{1 2}	1 x	Front apron –prime coated–, I-no. 288 and 636 ⇒ <i>Figure 2-1-</i> Material: PP-T20-HI
981.505.703.02.G2X	1 x	Towing lug cover –prime coated– ⇒ <i>Figure 2-2-</i> Material: PP-T20-HI
981.505.661.02 ¹	1 x	Retainer plate, left (for headlight washer system = I-no. 288, not shown)
981.505.662.02 ¹	1 x	Retainer plate, right (for headlight washer system = I-no. 288, not shown)
981.505.707.00	2 x	Holder for spacer (not shown)
981.505.563.03.OK1	1 x	Retaining frame, left-hand side –black matt– ⇒ <i>Figure 2-3-</i>
981.505.653.03.OK1	1 x	Retaining frame trim, left-hand side –black matt– (636) ⇒ <i>Figure 2-4-</i>

981.505.653.02.OK1	1 x	Retaining frame trim, left-hand side –black matt– (basic) ⇒ <i>Figure 2-5-</i>
981.505.793.01	1 x	Upper strut, left ⇒ <i>Figure 2-6-</i>
981.505.564.03.OK1	1 x	Retaining frame, right-hand side –black matt– ⇒ <i>Figure 2-7-</i>
981.505.654.03.OK1	1 x	Retaining frame trim, right-hand side –black matt– (636) ⇒ <i>Figure 2-8-</i>
981.505.654.02.OK1	1 x	Retaining frame trim, right-hand side –black matt– (basic) ⇒ <i>Figure 2-9-</i>
981.505.794.01	1 x	Upper strut, right ⇒ <i>Figure 2-10-</i>
981.631.187.00	1 x	Auxiliary headlight, left ⇒ <i>Figure 2-11-</i>
981.631.188.00	1 x	Auxiliary headlight, right ⇒ <i>Figure 2-12-</i>
981.575.221.00.1EO	1 x	Air guide, left –black– ⇒ <i>Figure 2-13-</i>
981.575.141.13.1EO	1 x	Air guide, center –black– (456) ⇒ <i>Figure 2-14-</i>
981.575.141.08.1EO	1 x	Air guide, center –black– (basic) ⇒ <i>Figure 2-15-</i>
981.575.222.00.1EO	1 x	Air guide, right –black– ⇒ <i>Figure 2-16-</i>
981.505.777.02	1 x	Foam part ⇒ <i>Figure 2-17-</i>
981.505.525.04.G2X	1 x	Spoiler on front apron –prime coated– ⇒ <i>Figure 2-18-</i> Material: PP-T20-HI
981.505.569.08.OK1	1 x	Retaining frame, centre –black matt– ⇒ <i>Figure 2-19-</i>
981.505.527.00.G2X	1 x	Spoiler trim, –prime coated– ⇒ <i>Figure 2-20-</i> Material: PP-T20-HI
981.505.557.04.1EO	1 x	Spoiler lip –black–, grained ⇒ <i>Figure 2-21-</i>
999.591.941.40	1 x	Expansion rivet St 4.2 (spoiler lip, not shown)
999.507.309.02	4 x	Speed nut, ST 4.8 (wheel arch, not shown)
999.507.164.01	5 x	Tie-wrap (not shown)
999.919.246.01	8 x	Oval-head screw, 6.0 x 18.0 -Q St 26 D0 (auxiliary headlights and strut, not shown)

1 **ONLY** contained in respective set!

2 **Including** glued holder for ParkAssist (I-no. 636)

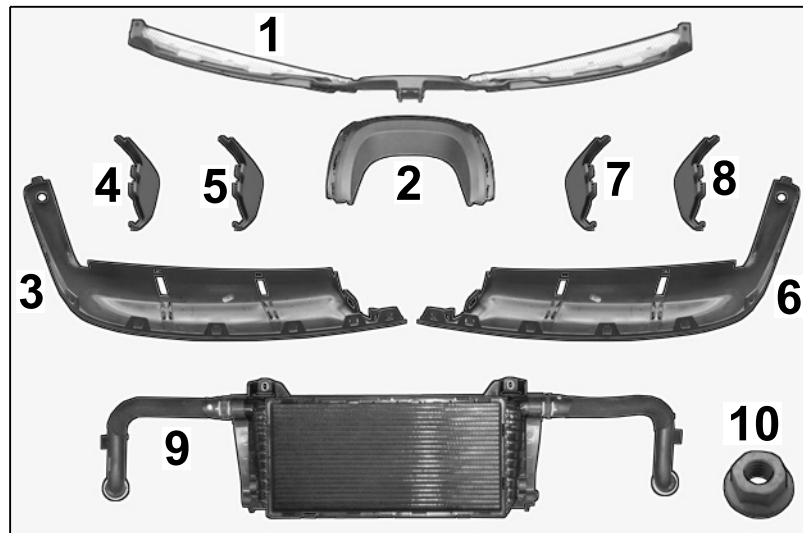

Figure 3

Parts for rear apron (⇒ Figure 3-1-8-):

— — —	1 x	Retaining frame assembly (ASSY), black incl. heat protection at left/right ⇒ Figure 3-1-
981.505.811.03.OK1	1 x	Trim frame for tailpipe cover, –black matt– ⇒ Figure 3-2-
981.505.511.02.G2X	1 x	Bottom of rear trim panel, left –prime coated–, basic (not shown) Material: PP-T20-HI
981.505.511.03.G2X	1 x	Bottom of rear trim panel, left –prime coated– (635/636) ⇒ Figure 3-3- Material: PP-T20-HI
981.505.613.00.G2X	1 x	Outer bar, left –prime coated– ⇒ Figure 3-4- Material: PP-T20-HI
981.505.615.00.G2X	1 x	Inner bar, left –prime coated– ⇒ Figure 3-5- Material: PP-T20-HI
981.505.512.02.G2X	1 x	Bottom of rear trim panel, right –prime coated–, basic (not shown) Material: PP-T20-HI
981.505.512.03.G2X	1 x	Bottom of rear trim panel, right –prime coated– (635/636) ⇒ Figure 3-6- Material: PP-T20-HI
981.505.616.00.G2X	1 x	Inner bar, right –prime coated– ⇒ Figure 3-7- Material: PP-T20-HI
981.505.614.00.G2X	1 x	Outer bar, right –prime coated– ⇒ Figure 3-8- Material: PP-T20-HI

Parts for radiator (⇒ Figure 3-9-10-):

991.106.037.02	1 x	–Middle– radiator ASSY ⇒ Figure 3-9-
900.377.010.01	4 x	M6 nut ⇒ Figure 3-10-

	999.507.246.01	2 x	Speed nut (not shown)
	999.073.220.09	2 x	Tapping screw, 4.8 x 25 ST (not shown)
Materials:	000.043.300.43	1 x	Adhesive, set including 5-part mixing tube for headlight washer system retainer plate
	000.043.301.47 ³	X x	Antifreeze, BASF Glysantin G40–91 EF; 1-liter container
	000.043.205.93	1 x	"KLUEBERPLUS S 06-100" grease; 100g tube (for fitting O-rings in cooling system)
	— — —	— —	Cleaning cloth (commercially available)
	— — —	— —	Isopropanol (commercially available)

³ As much as required.

Tools:	Nr.90 Pos.1 - Torque wrench	Gap dimension gauge
	9818 - PIWIS Tester II	shop light
	T10118 - Assembly tool	

Work Procedure: 1 Preparatory work



Painting components

- Risk of warping of components
 - Risk of damage to components
- ⇒ Observe the guidelines and instructions for painting components in the "Paint" Workshop Manual.
- ⇒ Always place parts without tension on the painting devices provided during painting and drying processes.

- 1.1 Paint all prime coated parts to match the vehicle's color code in accordance with instructions in the Paint Workshop Manual.
- 1.2 Drive the vehicle onto a lifting platform, connect a battery charger (⇒ *Workshop Manual '2X00IN Battery trickle charging*) and raise the vehicle (⇒ *Workshop Manual '4X00IN Lifting the vehicle*).
- 1.3 Remove front apron (⇒ *Workshop Manual '631519 Removing and installing front apron*).
- 1.4 Remove foam part (insert) on the bumper (⇒ *Workshop Manual '631019 Removing and installing front bumper*).

1.5 Remove air guide for side radiators (at the left/right) (⇒ *Workshop Manual '192419 Removing and installing air guide'*).

1.6 **ONLY** for vehicles with Automatic distance control (I-no. 456):
Remove control unit for distance measuring sensor (⇒ *Workshop Manual '278519 Removing and installing control unit for distance measuring sensor'*, ⇒ *Figure 4*).

- 1 – Distance measuring sensor control unit
- 2 – Pedestrian protection
- 3 – Stud, M6

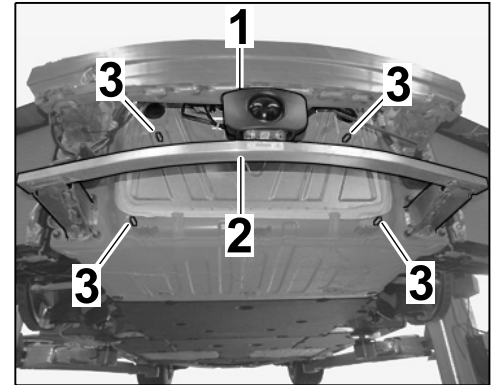

Figure 4

1.7 Remove pedestrian protection (⇒ *Figure 4 -2-*; ⇒ *Workshop Manual '697019 Removing and installing pedestrian protection'*).

1.8 **ONLY** for vehicles WITH –middle– radiator (I-no. 153):
Remove air guide for –middle– radiator (⇒ *Workshop Manual '192419 Removing and installing air guide'*)

1.9 Remove rear apron (⇒ *Workshop Manual '635519 Removing and installing rear apron'*)

2 **ONLY** for vehicles WITHOUT –middle– radiator (I-no. 153):
Install –middle– radiator (see also: ⇒ *Workshop Manual '198019 Removing and installing middle radiator'*).

2.1 Fit radiator assembly at the threaded bolt on the front panel using hexagon nuts (4 x M6), (⇒ *Workshop Manual '198019 Removing and installing middle radiator'*, ⇒ *Figure 5*)

Tightening torque 10 Nm (7.5 ftlb.)

- 1 – –Middle– radiator assembly
- 2 – Threaded bolt, M6 (right side)
- 3 – Water hose (right side)
- 4 – Side radiator (right side)
- 5 – Holder for water hose (right side)

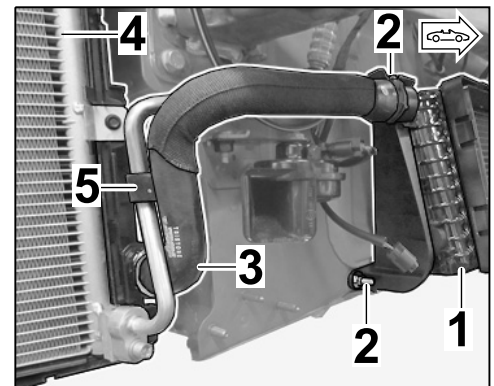

Figure 5



Caustic fluid

- **Danger of chemical burns**
- ⇒ **Avoid contact with caustic fluid.**

- ⇒ Wear personal protective gear.
- ⇒ Ensure that there is good ventilation.
- ⇒ If you do come into contact, wash off immediately with plenty of warm water and contact a doctor if necessary.

- 2.2 Place a suitable container underneath the side radiators.
- 2.3 Remove dummy plug at the bottom of the side radiator at the right and engage the right water hose for the –middle– radiator (⇒ *Figure 5-3-*) into the coupling on the side radiator.
Check that the plug connection is seated securely.
- 2.4 Fit water hose on the left side in the same way.
- 2.5 Clip holder (⇒ *Figure 5-5-*, on both water hoses) into the relevant line for the side radiator.

3 Converting front of vehicle for new front apron

- 1 – Pedestrian protection
- 2 – Air guide for –middle– radiator
- 3 – Distance measuring sensor control unit (456)
- 4 – Right air guide
- 5 – Left air guide
- 6 – Foam part (insert)

- 3.1 Install pedestrian protection (⇒ *Figure 6-1-*); (⇒ *Workshop Manual '697019 Removing and installing pedestrian protection*).
Tightening torque 23 Nm (17 ftlb.)
+/-2 Nm (+/-1.5 ftlb.)



Information

Check equipment variant!

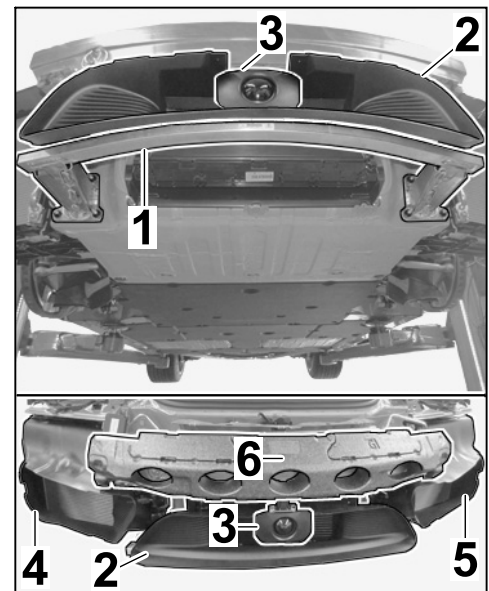

Figure 6

- 3.2 Install new air guide for –middle– radiator (⇒ *Figure 6-2-*) (⇒ *Workshop Manual '192419 Removing and installing air guide*)
- 3.3 Install new air guide for side radiators (at the right ⇒ *Figure 6-4-*/left ⇒ *Figure 6-5-*) (⇒ *Workshop Manual '192419 Removing and installing air guide*).
- 3.4 Install new foam part (insert ⇒ *Figure 6-6-*) on the bumper (⇒ *Workshop Manual '631019 Removing and installing front bumper*).

NOTICE

Components stored or set down incorrectly

- Risk of damage to component surfaces

⇒ Set the component down on a clean surface, workbench or assembly fixture.

4 Completing, assembling and installing new front apron

4.1 **ONLY** for vehicles with headlight washer system (I-no. 288):

Glue in retainer plate (left/right) for headlight washer system (⇒ *Workshop Manual '631555 Replacing front apron*).

4.1.1 Clean bonding surfaces to remove all dust and grease.

4.1.2 Position retainer plate for headlight washer system (left/right) at the relevant bore (spray nozzle for headlight washer system) on the inside of the front apron, align it and stick it on.

4.2 Assemble front apron.

- 1 – Spoiler trim
- 2 – Spoiler on front apron
- 3 – Front apron
- 4 – Spoiler lip

4.2.1 Fit spoiler trim into spoiler on front apron.

4.2.2 Fit holder for spacer at the underside of the front apron at the outside.

4.2.3 Fit spoiler for front apron into front apron.

4.2.4 Guide spoiler lip into the front apron from below and secure with expansion rivet St 4.2.

4.2.5 Install new towing lug cover (⇒ *Workshop Manual '631555 Replacing front apron*).

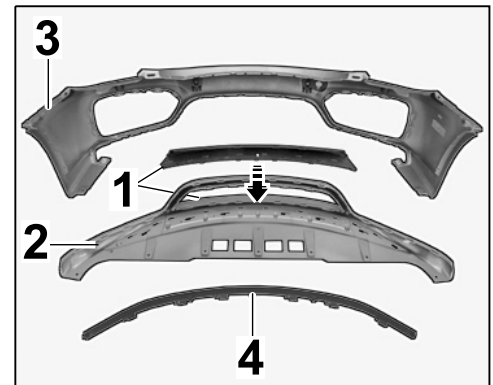

Figure 7

- 4.3 Install new centre retaining frame (⇒ *Workshop Manual '660519 Removing and installing radiator grille'*).

- 1 – Centre retaining frame
- 2 – Air grille, left side
- 3 – Air grille, right side

- 4.4 Fit new side air grilles (left/right) into the front apron (⇒ *Workshop Manual '660419 Removing and installing front air grille'*, ⇒ *Figure 8*)

Fit upper strut (at the left/right) into the relevant air grille and secure it.

Tightening torque 2 Nm (1.5 ftlb.)

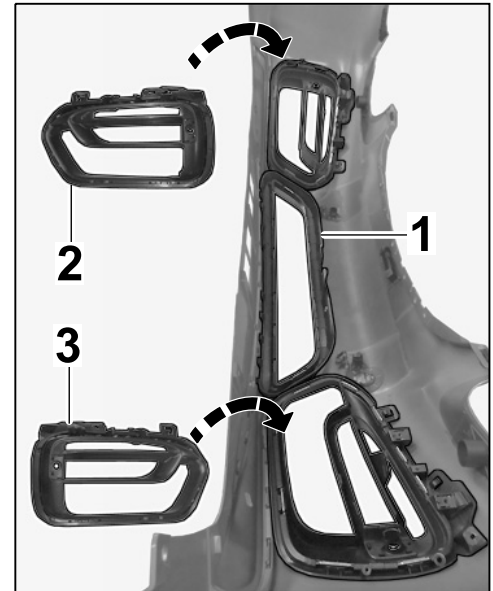

Figure 8

- 4.5 Convert front electric wire harness (⇒ *Workshop Manual '971519 Removing and installing front wire harness'*).

- 1 – Line mounting in direction indicator area (left side)
- 2 – Line routing in side air grille area (left side)
- 3 – Line routing in ParkAssist (636) area
- 4 – KESSY control unit (625)

- 4.5.1 **ONLY** for vehicles with front ParkAssist (I-no. 636 ⇒ *Figure 9 -3-*):
Convert ParkAssist sensors (⇒ *Workshop Manual '917519 Removing and installing ParkAssist sensor'*).

- 4.5.2 **ONLY** for vehicles with KESSY (I-no. 625 ⇒ *Figure 9-4-*):
Convert KESSY control unit (⇒ *Workshop Manual '966719 Removing and installing antenna for KESSY/PAS'*).

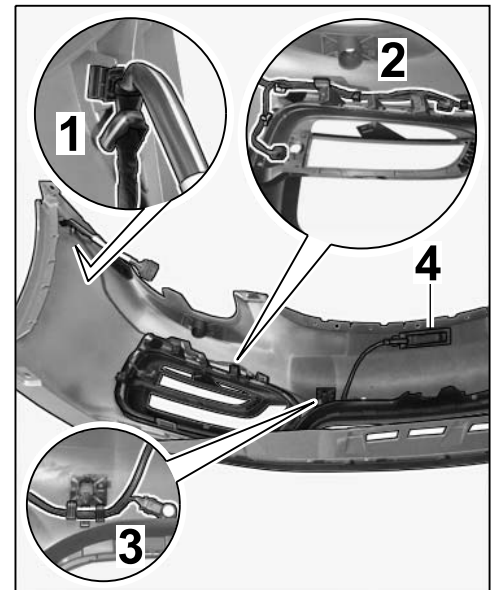

Figure 9



Information

Do NOT remove existing protective film from the auxiliary headlights! This protects the lamination on the lens and prevents chafing.

4.6 Convert auxiliary headlights (left/right) (⇒ *Workshop Manual '947119 Removing and installing auxiliary headlights'*).

- 1 – Auxiliary headlights (left side)
- 2 – Protective film on auxiliary headlights
- 3 – Spray nozzle for headlight washer system (left side, 288)
- 4 – Headlight washer system hose (288)

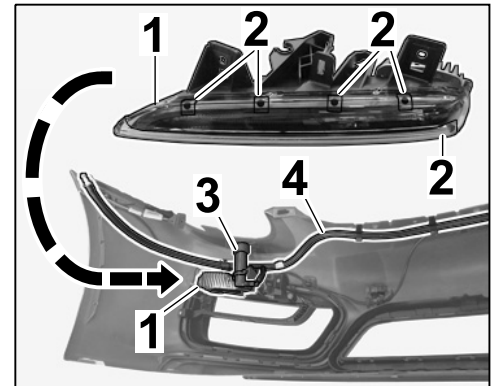

Figure 10

After installing the auxiliary headlights (left ⇒ *Figure 10-1-/right*), check gap dimension of auxiliary headlights (left/right) and re-position auxiliary headlights if necessary.

- 4.7 **ONLY** for vehicles with headlight washer system (I-no. 288):
Convert spray nozzles (left ⇒ *Figure 10-3-/right*) and hose for headlight washer system (⇒ *Figure 10-4-*) (⇒ *Workshop Manual '927219 Removing and installing headlight-washer spray nozzle'* and ⇒ *Workshop Manual '927719 Removing and installing hose for headlight washer system'*).
- 4.8 Convert direction indicator light (⇒ *Workshop Manual '945319 Removing and installing side direction indicator light'*).
- 4.9 Install front apron (⇒ *Workshop Manual '631519 Removing and installing front apron'*).

NOTICE

Components stored or set down incorrectly

- Risk of damage to component surfaces
- ⇒ Set the component down on a clean surface, workbench or assembly fixture.

- 5 Converting and installing rear apron
 - 5.1 Remove rear skirt and tailpipe cover trim frame from the rear apron (⇒ *Workshop Manual '636819 Removing and installing rear skirt'*)

5.2 Fit outer/inner bar into the relevant rear trim panel at the bottom (left/right).

- 1 – Outer bar, left
- 2 – Inner bar, left
- 3 – Bottom of rear side trim panel, left

5.2.1 Guide in locking lug on outer/inner bar at the relevant position on the respective trim panel (⇒ *Figure 11 -A-*).

5.2.2 Press outer/inner bar in the trim panel forward (⇒ *Figure 11 -B-*).

5.2.3 Press outer/inner bar in the trim panel as far down as required until the bar engages (⇒ *Figure 11 -C-*).

5.2.4 Check that the bars are fitted securely in the trim panel.

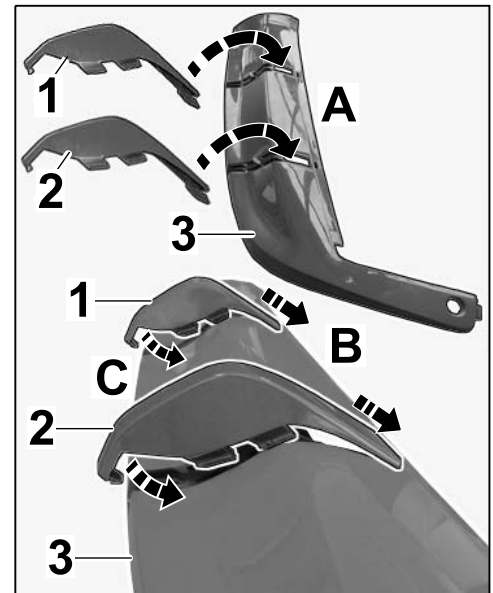

Figure 11

5.3 Clip painted bottom of rear trim panel (left) with new tailpipe cover trim frame and painted bottom of rear trim panel (right) together.

5.4 **ONLY** for vehicles with front/rear ParkAssist (635/636):
Convert ParkAssist sensors (⇒ *Workshop Manual '917519 Removing and installing ParkAssist sensor'*).

5.5 Fit black retaining frame assembly incl. heat protection on painted trim panels with a new trim frame for the tailpipe cover.

5.6 Fit painted rear skirt on rear apron (⇒ *Workshop Manual '636819 Removing and installing rear skirt'*).

5.7 Install rear apron (⇒ *Workshop Manual '635519 Removing and installing rear apron'*).

6 Concluding work

6.1 **9818 - PIWIS Tester II** must be connected before switching on the ignition.

NOTICE

Voltage drop

- Risk of irreparable damage to control unit
- Risk of damage to control unit
- Fault entries in the control unit
- Coding in the control unit is aborted
- Malfunctions in control unit, even during programming

- ⇒ Switch off the ignition and remove the ignition key before disconnecting the control unit.
- ⇒ Ensure that the power supply is not interrupted during programming.
- ⇒ Connect a battery charger with a current rating of at least Nominal value 40 A to the vehicle battery.

NOTICE

Control unit programming will be aborted if the Internet connection is unstable.

- An unstable Internet connection can interrupt communication between PIWIS Tester II and the vehicle communication module (VCI). As a result, control unit programming may be aborted.
- ⇒ During control unit programming, always connect PIWIS Tester II to the vehicle communication module (VCI) via the USB cable.



Information

The **9818 - PIWIS Tester 2** instructions take precedence since the description may be different with later Tester releases.

The procedure described here has been structured in general terms; different text or additions may appear on the **9818 - PIWIS Tester 2**.

- 6.2 Enter "SportDesign package" in the vehicle data.
 - 6.2.1 Select the required vehicle type. Press •F12" to continue.
 - 6.2.2 Press •F7" in the control unit overview to switch to the "Additional menu".
 - 6.2.3 Select the "Maintenance of vehicle data" function. Press •F12" until "X numbers" appears in the Value group column.
 - 6.2.4 Scroll to "SportDesign package" in the "Family" column and select "XAT – SPORT DESIGN pack. (Boxster)" there. Then press •F8" to save.

Press •F12" as soon as the message "Modified values have been buffered" appears.
 - 6.2.5 Press •F12" until modified values are displayed. Save the values by pressing •F8" .
 - 6.2.6 Wait until the message "Generation of the vehicle order is complete" appears. Continue to Log management by pressing •F12" .
 - 6.2.7 Press •F10" to open the log. Check that vehicle equipment "XAT – SPORT DESIGN pack. (Boxster)" is entered and close the log.
- 6.3 Code the new vehicle equipment.

- 6.3.1 Switch to the "Codings/adaptations" menu and select "Automatic coding with coding rules". Press •F12" to continue.
- 6.3.2 Select all control units in the control unit overview (•CTRL+A") and switch to the "Codings/adaptations" column.
- 6.3.3 Select Automatic coding. Press •F12" to continue.
- 6.4 Once coding is completed successfully: Read out the fault memory of all systems, work through any existing faults and erase the fault memory (⇒ *Workshop Manual '033500 Fault memory for on-board diagnosis*).
- 6.5 **ONLY** for vehicles WITHOUT –middle– radiator (I-no. 153):
Top up coolant and bleed the cooling system (⇒ *Workshop Manual '193817 Draining and filling coolant (includes bleeding)*).
- 6.6 Switch off the ignition and disconnect **9818 - PIWIS Tester II**.
- 6.7 Disconnect the battery charger (⇒ *Workshop Manual '2X00IN Battery trickle charging*) and drive the vehicle off the lifting platform.

63 68 61 66:	–Rear skirt (1 ea.) with bars (SportDesign package), new part painted– Includes: Materials: 3 MU Without: Paint preparation (separate LO No.)!	Labor time: 40 TU
63 68 61 61:	–Rear skirt (2 ea.) with bars (SportDesign package), new part painted– Includes: Materials: 5 MU Without: Paint preparation (separate LO No.)!	Labor time: 70 TU
66 03 61 66:	–Trim for spoiler on front apron (SportDesign package), new part painted– Includes: Materials: 1 MU Without: Paint preparation (separate LO No.)!	Labor time: 30 TU
66 03 61 61:	–Spoiler on front apron (SportDesign package), new part painted– Includes: Materials: 7 MU Without: Paint preparation (separate LO No.)!	Labor time: 90 TU
63 15 61 51:	–Front apron (SportDesign package), new part painted– Includes: Materials: 15 MU Without: Paint preparation (separate LO No.)!	Labor time: 130 TU

- 66 99 62 51: –SportDesign package complete (rear skirt with bars, spoiler for front apron and front apron), new part painted–
Includes: Materials: 27 MU
Without: Paint preparation (separate LO No.)! Labor time: **310 TU**
- 51 01 71 05: -Preparing body paintwork–
Includes: Order-based;
New part painting Step 1;
Plastic part Labor time: **130 TU**
- 66 99 31 00: **ONLY** for vehicles WITH –middle– radiator:
–SportDesign package installed–
Includes: Removing and installing front apron, completing new front apron and fitting new spoiler on front apron.
Removing and installing rear apron, completing new rear skirt and fitting it on rear apron.
Testing front lights and 3rd brake light.
Programming/coding "SportDesign package – XAT" option. Labor time: **317 TU**
- 66 99 31 03: **ONLY** for vehicles WITHOUT –middle– radiator:
–SportDesign package installed–
Includes: Removing and installing front apron, completing new front apron and fitting new spoiler on front apron.
Installing –middle– radiator.
Removing and installing rear apron, completing new rear skirt and fitting it on rear apron.
Testing front lights and 3rd brake light.
Programming/coding "SportDesign package – XAT" option.
Without: Bleeding the cooling system (separate LO No.)! Labor time: **363 TU**
- 19 01 07 50: **ONLY** for vehicles WITHOUT –middle– radiator:

–Bleeding the cooling system–

Labor time: **65 TU**

Important Notice: Technical Bulletins issued by Porsche Cars North America, Inc. are intended only for use by professional automotive technicians who have attended Porsche service training courses. They are written to inform those technicians of conditions that may occur on some Porsche vehicles, or to provide information that could assist in the proper servicing of a vehicle. Porsche special tools may be necessary in order to perform certain operations identified in these bulletins. Use of tools and procedures other than those Porsche recommends in these bulletins may be detrimental to the safe operation of your vehicle, and may endanger the people working on it. Properly trained Porsche technicians have the equipment, tools, safety instructions, and know-how to do the job properly and safely. If a particular condition is described, do not assume that the bulletin applies to your vehicle, or that your vehicle will have that condition. See your authorized Porsche Dealer for the latest information about whether a particular technical bulletin applies to your vehicle. Part numbers listed in these bulletins are for reference only. Always check with your authorized Porsche dealer to verify the current and correct part numbers. The work procedures updated electronically in the Porsche PIWIS diagnostic and testing device take precedence and, in the event of a discrepancy, the work procedures in the PIWIS Tester are the ones that must be followed.

© Porsche Cars North America, Inc.

Dealership	Service Manager	Shop Foreman	Service Technician
Distribution	Asst. Manager	Warranty Admin.	Service Technician
Routing			

Dr. Ing. h.c. F. Porsche AG is the owner of numerous trademarks, both registered and unregistered, including without limitation the Porsche Crest®, Porsche®, Boxster®, Carrera®, Cayenne®, Cayman®, Macan®, Panamera®, Speedster®, Spyder®, 918 Spyder®, Tiptronic®, VarioCam®, PCM®, PDK®, 911®, RS®, 4S®, FOUR, UNCOMPROMISED®, and the model numbers and the distinctive shapes of the Porsche automobiles such as, the federally registered 911 and Boxster automobiles. The third party trademarks contained herein are the properties of their respective owners. Porsche Cars North America, Inc. believes the specifications to be correct at the time of printing. Specifications, performance standards, standard equipment, options, and other elements shown are subject to change without notice. Some options may be unavailable when a car is built. Some vehicles may be shown with non-U.S. equipment. The information contained herein is for internal authorized Porsche dealer use only and cannot be copied or distributed. Porsche recommends seat belt usage and observance of traffic laws at all times.

Printed in the USA